

HSF

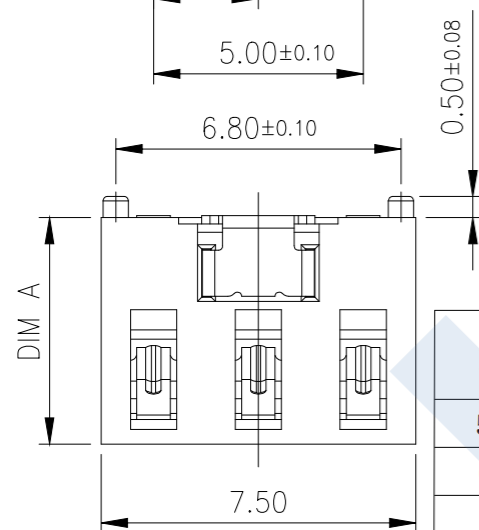

ROHS

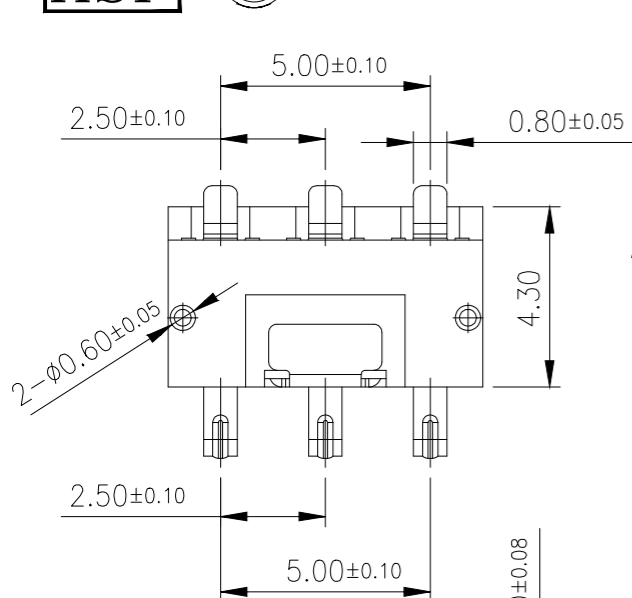

ALL SOLDER TAIL &amp; PEG

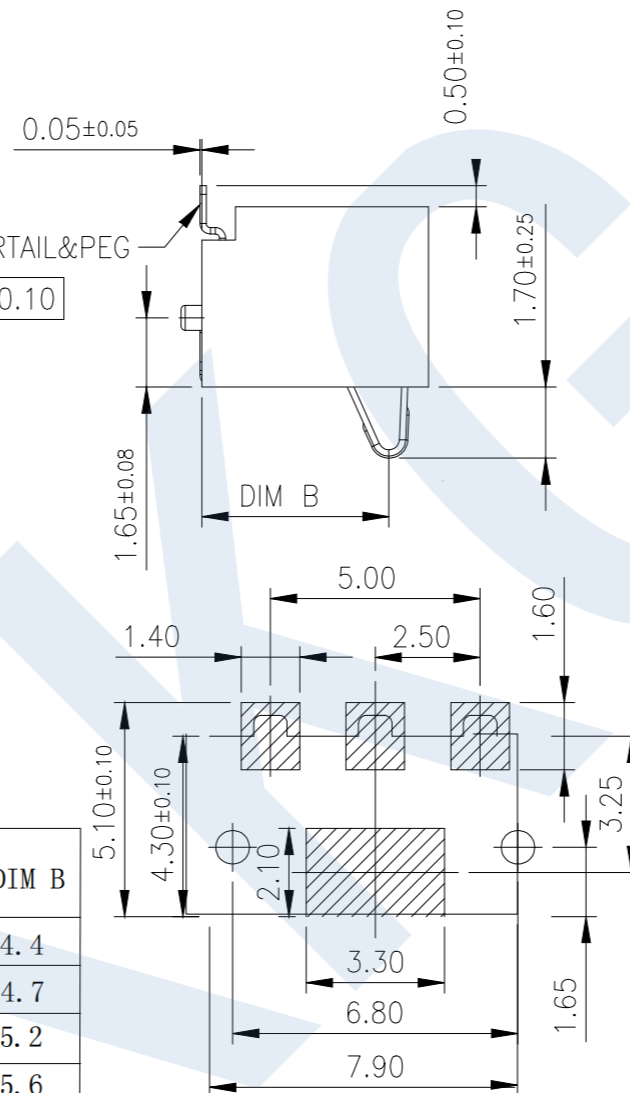
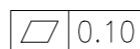

H=?	DIM A	DIM B
5.4	5.4	4.4
6.0	6.0	4.7
6.5	6.5	5.2
7.0	7.0	5.6
7.5	7.5	6.5
8.0	8.0	6.7
8.5	8.5	7.2

RECOMMENDED PCB LAYOUT  
TOP VIEW (.XX±0.05)

## ELECTRICAL PERFORMANCES:

RATING CURRENT: 2.0 A

RATING VOLTAGE : 250 V AC

CONTACT RESISTANCE: 30mΩ

INSULATION RESISTANCE: 1000mΩ

DIELECTRIC WITHSTANDING VOLTAGE :

1000V AC for 1 minute

## MECHANICAL PERFORMANCE:

DURABILITY: 5000 times

NORMAL FORCE AT MATING POSITION: 80g min

OPERATION TEMPERATURE: -55℃~+125℃

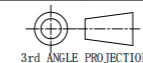
Unless Otherwise specified tolerance  
X. ±0.35 X.XX: ±0.20  
X.X: ±0.25 X.XXX: ±0.15SCALE:  
As Shown  
DRAW  
Wu Feng Rong  
CHECK  
BobYang  
UNIT:  
mm  
DATE  
10/03/2020  
DATE  
22/03/2018

KKG

TITLE:

3 Circuit Battery 2.5MM Connector

DRAWING NO: BC-043

PRODUCT NO: BC-043

REV

DESCRIPTION

DATE